

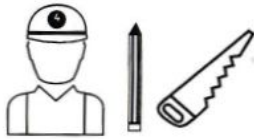

**Nowodvorski**  
LIGHTING



**LVM RECESSED TRACK**

10156  
10157



**LVM TRACK**

10162  
10163

**1 Flush low-voltage rail installation** Surface mounted low-voltage track ceiling/hanging wire installation

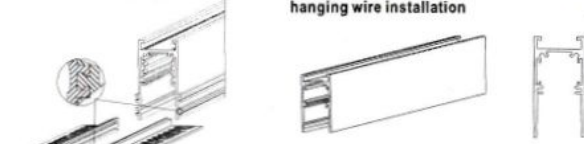

According to the actual plank during installation select the installation card slot for thickness, and installation direction

**Installation mode one**  
Fix the board directly (the short side of the mounting piece is facing down, The fixed slot snaps into the bottom slot)

**Installation mode two**  
The upper and lower wooden boards are locked and installed (the thickness of the board is not more than 9mm) (The short side of the mounting plate is facing down, and the fixing slot is snapped into the top slot)

**Installation mode three**  
The upper and lower wooden boards are locked and installed (the thickness of the board is not more than 12mm) (the short side of the mounting piece is facing up, and the fixing slot is inserted into the top slot)

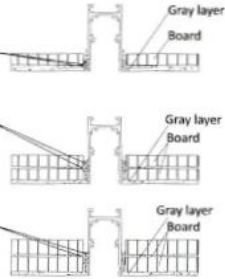

**2 Flush low-voltage rail installation** Surface mounted low pressure track ceiling mount

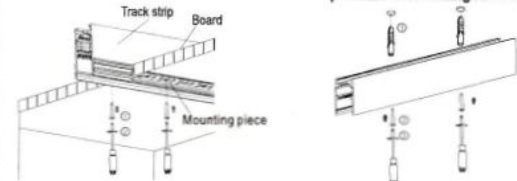

**Surface-mounted low-voltage rail hanging wire installation**

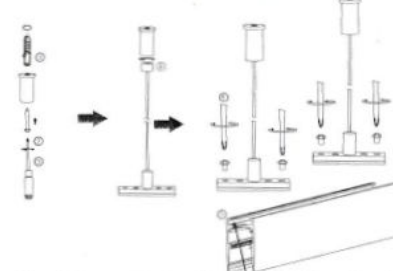

The reinforcement piece is inserted into the rail from here

**3 Built-in power wiring**

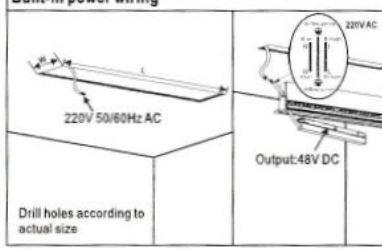

**External power supply wiring**

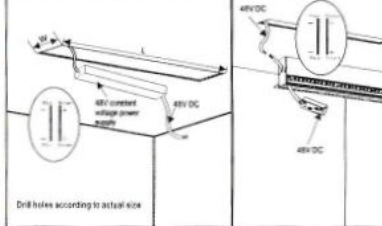

**4 Magnetic suction system splicing method**

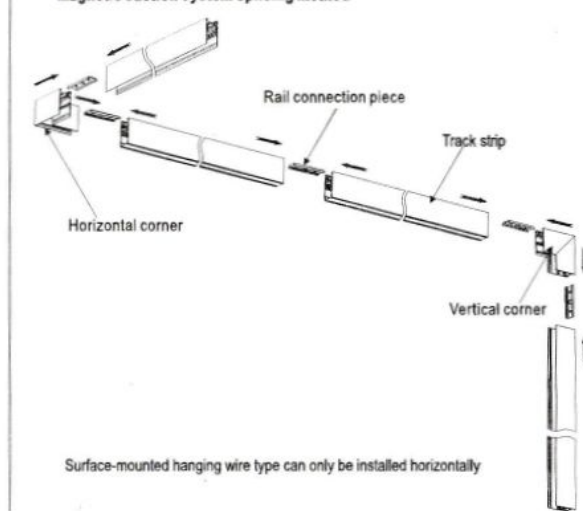

Surface-mounted hanging wire type can only be installed horizontally

**5 Batch ash**

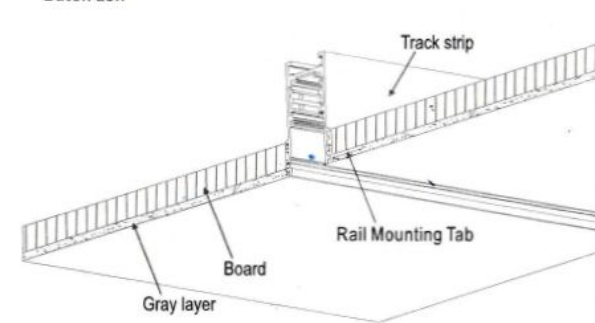

The embedded installation type requires ash, and the surface installation and hanging wire type do not need this operation.

**6 Connector installation**

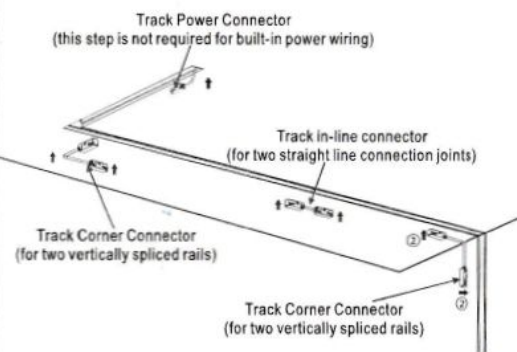

All connectors are used in the same manner

**7 Lamp installation**

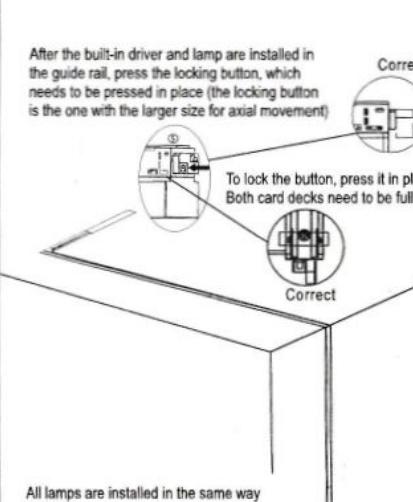

All lamps are installed in the same way

**8 Finish installation**

